

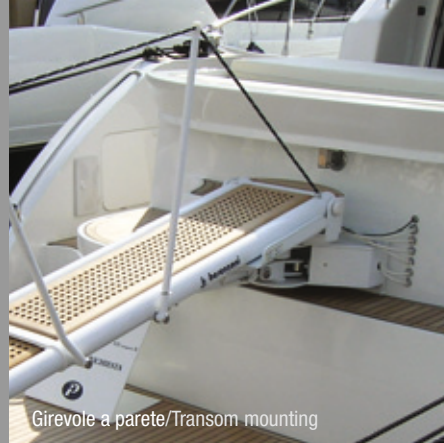

## PI 464

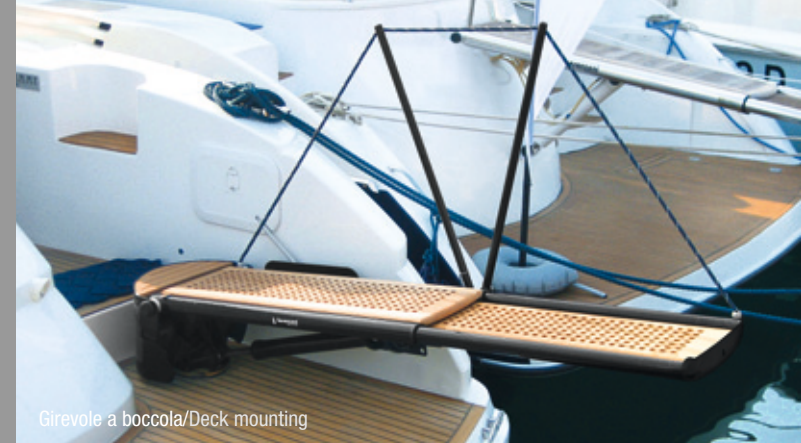

Girevole a parete/Transom mounting



Girevole a boccola/Deck mounting

### Smart Girevole

- Passerella telescopica e girevole con funzioni automatiche
  - Raggruppa funzione di passerella e gruetta per il sollevamento di tender
  - Struttura in acciaio inox lucido o verniciato
  - Pedana di camminamento in carabottino di teak
  - Possibilità di installazione sul deck o sullo specchio di poppa
  - Candelieri automatici con corda
  - Fornita con centralina idraulica ed elettrica già cablata
  - Pompa manuale in caso di emergenza
  - Telecomando e pannello di controllo per il comando dal pozzetto
- 
- Telescopic and rotating gangway with automatic functions for telescoping and elevation
  - Gangway and crane function to lift a tender
  - Structure made in polished or powder coated stainless steel
  - Grating boardwalk made in teak
  - Rotating base for deck or transom mounting
  - Automatic rope handrail
  - Manual pump for emergency
  - Remote and touchpad panel remote control to operate from the cockpit

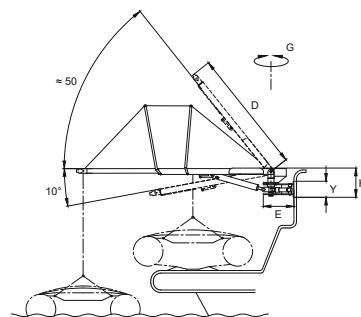

Girevole a parete  
Transom mounting

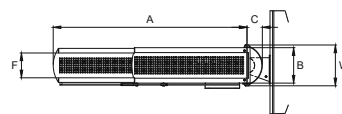

Girevole a boccola  
Deck mounting

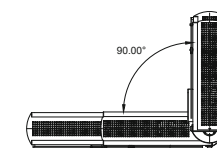
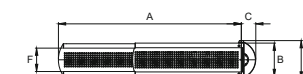
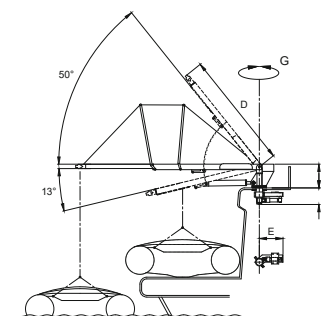

Lifting capacity kg	110	100	150
A mm	1910	2230	2540
B mm	430	430	462
C mm	200	200	200
D mm	1160	1350	1620
E mm	400	400	400
F mm	320	320	325
G (°)	90	90	90
H mm	370	370	385
W mm	500	500	525
Y mm	210	210	210
<b>Weight kg</b>	<b>125</b>	<b>155</b>	<b>165</b>

Lifting capacity kg	110	100	150
A mm	1910	2230	2530
B mm	430	430	462
C mm	200	200	200
D mm	1150	1320	1620
E mm	400	400	400
F mm	330	330	320
G (°)	90	90	90
H mm	330	330	330
W mm	532	532	532
Y mm	230	230	230
<b>Weight kg</b>	<b>115</b>	<b>140</b>	<b>150</b>