



GINEICO

THEKLA 9W D00

CATEGORY

DOWNLIGHT



GENERAL FEATURES		MATERIALS	
IP Protection grade	IP65	BEZEL	AISI 316 STAINLESS STEEL / SATIN / WHITE 9010
Installation on	CEILING	BODY	PLASTIC
Molding	Ø 155 mm	DIFFUSER	GLASS
Recess	25 mm		
Mounting hole	Ø 114 mm		
Weight	365 gr		
Fixing system	SCREWS		
Orientable	No		
Flexible	No		
Switch	No		

ELECTRICAL SPECIFICATIONS			
TYPE OF POWER		Constant Voltage	
Light source	40 HIGH LUMINOSITY LED		
Light Type	Bicolor		
Power supply	10-30 Vdc/POS COM		
Power consumption	9 W	Secondary light power	4W
Absorption			
Dimmable / Recommended dimmer	Yes / FASP094CA2A3A00 HDIM300	Dimmer mode	PWM

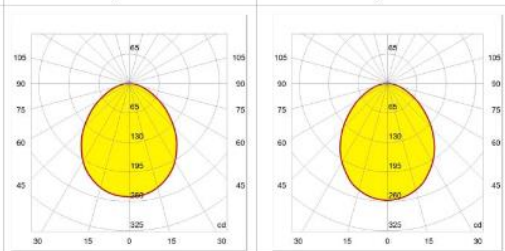
PHOTOMETRIC DATA					
Color Temperature		WARM WHITE (2900-3100 °K)	DAY LIGHT (3800-4100 °K)	COOL WHITE (5500-6000 °K)	
CRI		90	90		
Luminous flux		596 lm	605 lm		
Luminous efficacy		66 lm/W	67 lm/W		
Ø at 1 m	2,15 m	250 lux	257,8 lux		
Ø at 2 m	4,31 m	62,5 lux	64,5 lux		
Ø at 3 m	6,46 m	27,8 lux	28,6 lux		
ANGLE	95°				

CERTIFICATIONS



G45, 76-84 WATERWAY DRIVE COOMERA, QUEENSLAND, 4209, AUSTRALIA.

PHONE: (+61) 7 5556 0244

EMAIL: SALES@GINEICO.COM

WWW.GINEICOMARINE.COM.AU

CATEGORY

DOWNLIGHT

Dimensions - mm (inches)

SPECIFICATION FOR THE CONNECTION OF INDIVIDUAL UNIT

POWER: 9 W

POWER SUPPLY: 10-30 Vdc/POS COM

OPERATING VOLTAGE

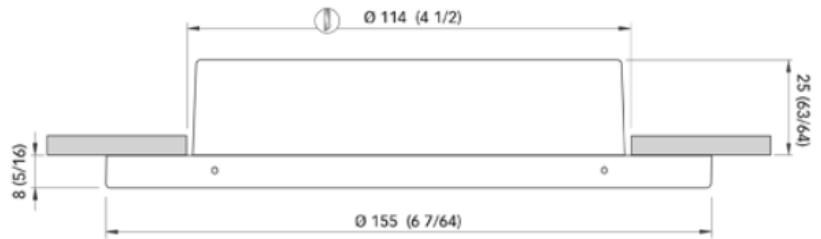

CONNECTION INFORMATION

WARNINGS

Use the unit in ultra-low voltage (SELV) .
Do not plug the unit directly into the wall socket (AC).

GENERAL INFORMATION TO CONNECT MORE THAN ONE DEVICE

This product can be connected in parallel

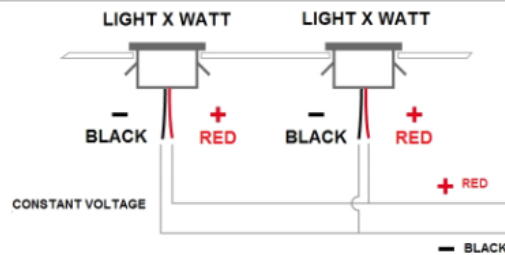

INSTRUCTIONS FOR ASSEMBLY

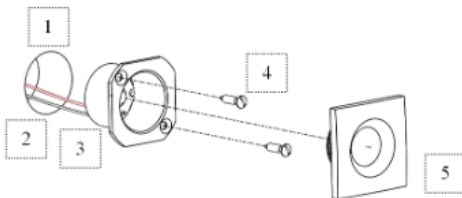

1. Make the hole for the corresponding product, according to the size recommended in the scheme.
2. The wires coming from the power supply (at the voltage provided for by the chart) must be present in the panel where the light will be installed.
3. The spot light is equipped with fast-on male connectors on the wires. Cut the wires to remove the fast-on connectors when the application does not require them.
Connection: the positive is the red wire, the negative is the black wire; test the product's functioning.
4. Secure the spot light to the panel using self-tapping screws.
5. Install the frame on the spot light by applying pressure.